

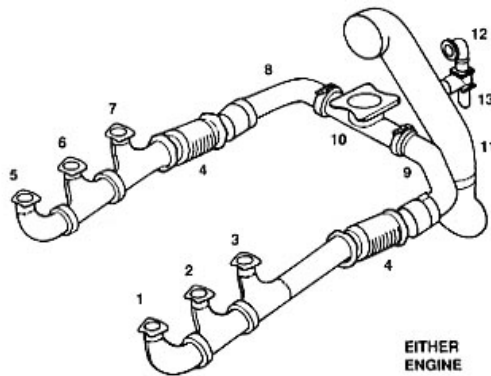

Wall Colmonoy Corporation
4700 SE 59th Street, Oklahoma City, OK 73135
Tel - 405-672-1361 – Fax – 405-670-3763
1-800-433-5074
aircraftexhaust@wallcolmonoy.com

CESSNA, Models 340, 340A, 414							
Model 414, S/N 0001 thru 0800 with Continental Engine TS10-520-J or -JB							
		OEM	New	O/H	July 2000		
Item		Cessna	WCC	WCC	Mfg.	O/H	Core
No.	Description	P/N	P/N	P/N	Price	List Price	Charge
1,2,3	Stack assembly, L.H.	9910295-9/13	Ram	9910295-9R/13R	N/A	Call	Call
4	Slip joint	-	-	1001-3R	N/A	Call	Call
5,6,7	Stack assembly, R.H.	9910295-10/14	Ram	9910295-10R/14R	N/A	Call	Call
8	Elbow, R.H.	9910299-4	Ram	9910299-4R	N/A	Call	Call
9	Elbow, L.H.	9910299-3	Ram	9910299-3R	N/A	Call	Call
10	Wye	9910299-8	8226-9	9910299-8R	Call	Call	Call
10	Wye	9910299-9	8226-11	9910299-9R	Call	Call	Call
11	Tailpipe, L.H.	9910299-1	-	9910299-1R	N/A	Call	Call
11	Tailpipe, R.H.	9910299-2	-	9910299-2R	N/A	Call	Call
12	Elbow assembly	9910299-5	Ram	9910299-5R	N/A	Call	Call
13	Pipe assembly	5654551-3	-	5654551-3R	N/A	Call	Call



We recommend slip-joint type stacks be ordered as assemblies to assure joint integrity.

Note: For new Inconel parts, contact Ram Aircraft at 254-752-8381
We recommend purchasing stacks as complete assemblies for proper slip-joint fit